





Map Key

-  Underground Station
-  Mainline Train Station
-  Regent's Canal
-  Favourite Destination



- 1 Almeida Theatre
- 2 Sadler's Wells Theatre
- 3 The Old Red Lion Theatre Pub
- 4 The Screen On The Green
- 5 St Luke's Symphony Orchestra
- 6 O2 Academy Islington
- 7 Victoria Miro Gallery
- 8 Electrowerkz
- 9 The King's Head Theatre Pub
- 10 Islington Museum
- 11 XOYO Club



- 12 The Duke of Cambridge
- 13 Narrowboat
- 14 The Earl of Essex
- 15 The Island Queen
- 16 Ottolenghi
- 17 The Old Queen's Head
- 18 Mokapot
- 19 Euphorium Bakery
- 20 Wenlock & Essex
- 21 Frederick's Restaurant
- 22 Kipferl
- 23 The Hanbury Arms
- 24 The Angel Building
- 25 The Eagle
- 26 Jamie Oliver's Fifteen
- 27 Nightjar
- 28 Paper Mache Tiger
- 29 John Salt
- 30 MyChocolate

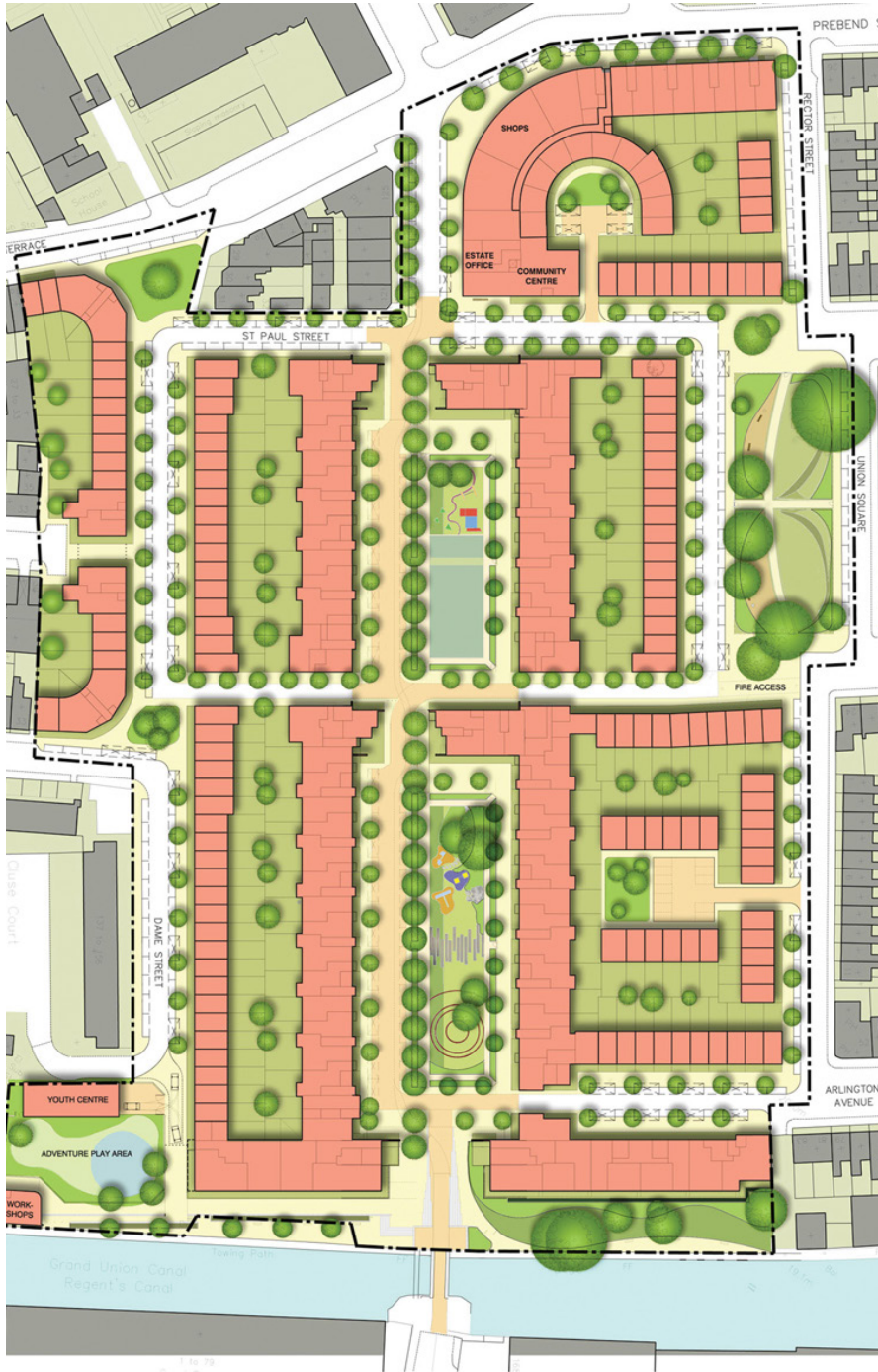

Mins Getting around on the tube from Angel Station *

- 2 King's Cross & St Pancras
- 6 Bank
- 8 London Bridge
- 10 Liverpool Street
- 12 Oxford Circus
- 21 Shoreditch High Street
- 23 Stratford
- 25 Paddington



Mins Exploring is easy on your bike *

- 7 Shoreditch
- 8 Old Street
- 12 Victoria Park
- 15 Clissold Park
- 15 King's Cross
- 17 Camden Town
- 20 Regent's Park
- 20 The Olympic Park

Pollard Thomas Edwards winning proposal to redevelop the Packard Estate in 2005